

# HIDEOUT

TRAVEL TRAILERS · SPORT TRAVEL TRAILERS

2023 EASTERN + 2023 WESTERN



KEYSTONE  
RV COMPANY

CAMP BETTER

# HIDEOUT

TRAVEL TRAILERS · SPORT TRAVEL TRAILERS

2023 EAST



KEYSTONE  
RV COMPANY

CAMP BETTER





HIDEOUT 29DFS



HIDEOUT 29DFS

## 2023 HIDEOUT | EXCEPTIONAL FEATURES

- SOLARFLEX™ 200 SOLAR POWER SYSTEM W/OPTIONAL DRAGONFLY ENERGY LITHIUM-ION BATTERY
- **NEW** GIRARD TANKLESS WATER HEATER
- CENTRAL VACUUM (N/A ON SPORT)
- BLADE™ HIGH-PERFORMANCE AIR FLOW SYSTEM (N/A ON SPORT)
- TINTED WINDOWS (N/A ON SPORT)
- PORCELAIN TOILET (N/A ON SPORT)
- **NEW** MEDICINE CABINET ABOVE BATHROOM SINK
- **NEW** RESILIENT VINYL FLOORING IN SLIDE ROOMS (N/A ON SPORT)
- SEAMLESS KITCHEN COUNTERTOPS
- **NEW**.040" SMOOTH METAL FRONT (N/A ON SPORT)
- SOLIDSTEP® AT MAIN ENTRY DOOR (N/A 38s)
- EXTRA-LARGE GRAB HANDLE
- WINEGARD™ AIR 360+ OMNIDIRECTIONAL ANTENNA WITH WI-FI/4G LTE
- POWER STABILIZER JACKS (N/A ON SPORT & 38s)
- POWER TONGUE JACK (N/A ON SPORT & 38s)

| MODEL         | WEIGHT | CARRYING CAPACITY | HITCH WEIGHT | FRESH WATER** | WASTE WATER | GRAY WATER | LPG | LENGTH* | WIDTH | HEIGHT | AWNING |
|---------------|--------|-------------------|--------------|---------------|-------------|------------|-----|---------|-------|--------|--------|
| 174RK         | 4085   | 1115              | 525          | 21            | 30          | 30         | 20  | 21' 5"  | 8'    | 10' 2" | 10'    |
| 175BH         | 3428   | 972               | 485          | 21            | 30          | 30         | 20  | 21' 5"  | 8'    | 10' 2" | 10'    |
| 176BH         | 3810   | 690               | 520          | 21            | 30          | 30         | 20  | 21' 5"  | 8'    | 10' 2" | 10'    |
| 177RD         | 3397   | 1003              | 540          | 21            | 30          | 30         | 20  | 21' 5"  | 8'    | 10' 2" | 10'    |
| 179RB         | 3753   | 727               | 480          | 21            | 32          | 30         | 20  | 21' 5"  | 8'    | 10' 2" | 10'    |
| 181BH         | TBD    | TBD               | TBD          | 21            | 30          | 60         | 20  | 22' 9"  | 8'    | 10' 4" | 15'    |
| 186SS         | 4291   | 709               | 610          | 21            | 30          | 30         | 20  | 22' 10" | 8'    | 10' 4" | 14'    |
| 201BH         | TBD    | TBD               | TBD          | 21            | TBD         | TBD        | TBD | TBD     | 8'    | TBD    | TBD    |
| 20RDN (202RD) | TBD    | TBD               | TBD          | 37            | 39          | 39         | 40  | 24' 11" | 8'    | 10' 3" | 12'    |
| 22MLS         | TBD    | TBD               | TBD          | 37            | 39          | 39         | 40  | 26' 4"  | 8'    | 11' 1" | 16'    |
| 24RBS         | TBD    | TBD               | TBD          | 37            | TBD         | TBD        | TBD | TBD     | 8'    | TBD    | TBD    |
| 25BHN (262BH) | TBD    | TBD               | TBD          | 37            | 30          | 39         | 40  | 29' 3"  | 8'    | 10' 3" | 12'    |
| 25BHS         | TBD    | TBD               | TBD          | 37            | TBD         | TBD        | TBD | TBD     | 8'    | TBD    | TBD    |
| 25RDS         | 6195   | 1405              | 1010         | 37            | 30          | 39         | 40  | 29' 7"  | 8'    | 11' 1" | 18'    |
| 26BHS (272BH) | TBD    | TBD               | TBD          | 37            | 30          | 30         | 40  | 30' 8"  | 8'    | 11' 1" | 16'    |
| 28RKS         | 7012   | 2648              | 860          | 37            | 39          | 78         | 40  | 32' 11" | 8'    | 11' 1" | 18'    |
| 29DFS         | 7126   | 2554              | 920          | 37            | 30          | 78         | 40  | 33' 11" | 8'    | 11' 1" | 16'    |
| 29QBS (290QB) | TBD    | TBD               | TBD          | 37            | 39          | 39         | 40  | 33' 3"  | 8'    | 11' 1" | 18'    |
| 31BRD (318BR) | TBD    | TBD               | TBD          | 37            | 39          | 69         | 40  | 35' 11" | 8'    | 11' 2" | 18'    |
| 32LBH         | 7516   | 2284              | 1045         | 37            | 30          | 69         | 40  | 36' 6"  | 8'    | 11' 0" | 18'    |
| 34FKDS        | 8394   | 1506              | 1100         | 37            | 39          | 78         | 40  | 38' 11" | 8'    | 11' 2" | 18'    |
| 38BHDS        | 8306   | 1664              | 1170         | 37            | 39          | 39         | 60  | 39' 11" | 8'    | 11' 2" | 18'    |
| 38FDDS        | 8519   | 1481              | 1205         | 37            | 39          | 39         | 60  | 39' 11" | 8'    | 11' 2" | 18'    |
| 38FKTS        | 9286   | 1714              | 1200         | 37            | 39          | 78         | 60  | 39' 11" | 8'    | 11' 4" | 18'    |
| 38FQTS        | 9350   | 2010              | 1200         | 37            | 78          | 78         | 60  | 39' 11" | 8'    | 11' 4" | 18'    |



# HIDEOUT

Keystone Hideout RVs make it incredibly easy to become a camper. Choose from a wide selection of floorplans from sport travel trailer models to bunkhouses roomy enough for the entire family (and a few neighbor kids)! You'll fall in love with Hideout's airy interiors and dialed-in features – all at affordable price points.



"The layout of our unit is perfect for us. We are retirees with two small dogs. The dinette slideout gives us and the puppies plenty of floor space. The countertop space is great and gives us room for our small TV and food prep. The Murphy bed with the couch is also a big plus. Pulling this small RV with my half-ton is also easy."

— HIDEOUT 174RK OWNER

VISIT OUR WEBSITE FOR PHOTOS,  
360° TOURS, AND FULL PRODUCT DETAILS



**NEW TO CAMPING?** Keystone RV's Matt Ardnt & Bart Taylor walk you through everything you need to know from your pre-travel checklist to full campsite set-up. You can find this series on Keystone's YouTube channel or follow this QR code to our website.

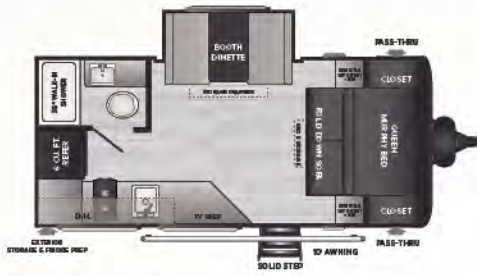

**174RK** | WEIGHT 4085 | LENGTH 21' 5"

**SPORT** • BOOTH DINETTE, REAR KITCHEN SLIDE, MURPHY BED

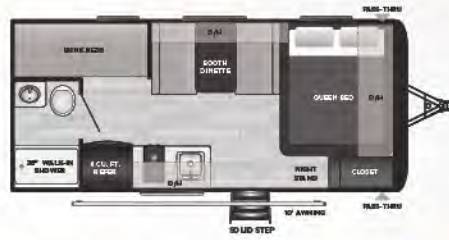

**175BH** | WEIGHT 3428 | LENGTH 21' 5"

**SPORT** • NON-SLIDE, SINGLE BUNKS

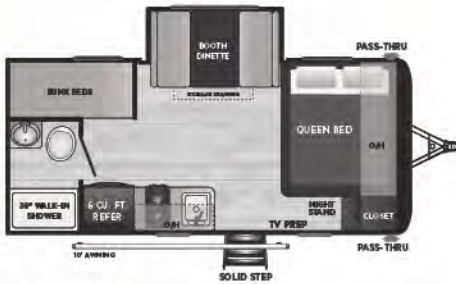

**176BH** | WEIGHT 3810 | LENGTH 21' 5"

**SPORT** • BOOTH DINETTE SLIDE, SINGLE BUNKS

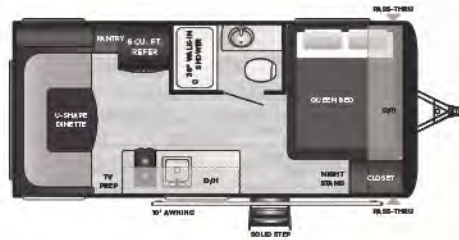

**177RD** | WEIGHT 3397 | LENGTH 21' 5"

**SPORT** • NON-SLIDE, REAR DINETTE

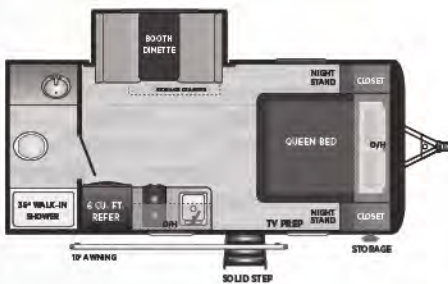

**179RB** | WEIGHT 3753 | LENGTH 21' 5"

**SPORT** • BOOTH DINETTE SLIDE, REAR BATHROOM

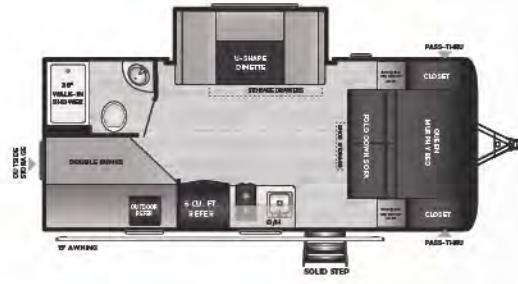

**181BH** | WEIGHT 4580 | LENGTH 22' 9"

**SPORT** • U-SHAPE DINETTE SLIDE, DOUBLE BUNKS, MURPHY BED

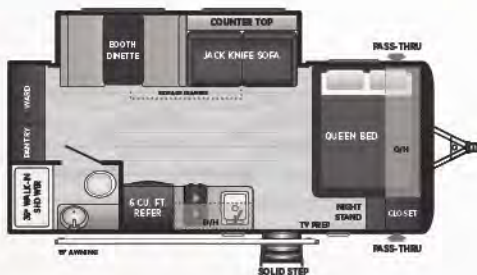

**186SS** | WEIGHT 4291 | LENGTH 22' 10"

**SPORT** • SUPER SLIDE, REAR PANTRY/WARDROBE

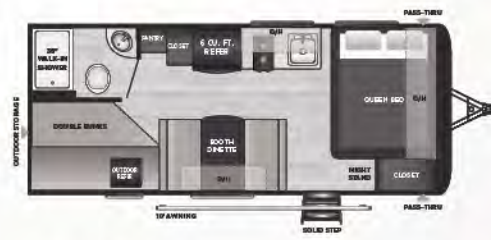

**201BH** | WEIGHT TBD | LENGTH TBD

**SPORT** • NON-SLIDE DOUBLE BUNKS



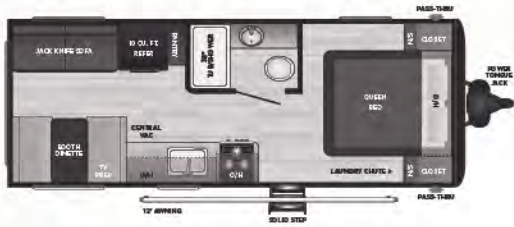

**20RDN** | WEIGHT TBD | LENGTH 24' 11"

• NON-SLIDE, REAR DINETTE, LARGE REAR WINDOWS

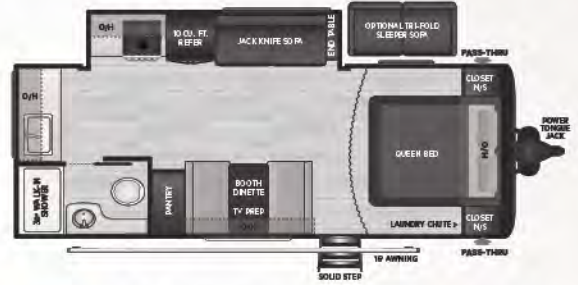

**NEW!** 22MLS | WEIGHT 5525 | LENGTH 26' 4"

• COMBO SLIDE, MIDDLE LIVING, OPEN CONCEPT

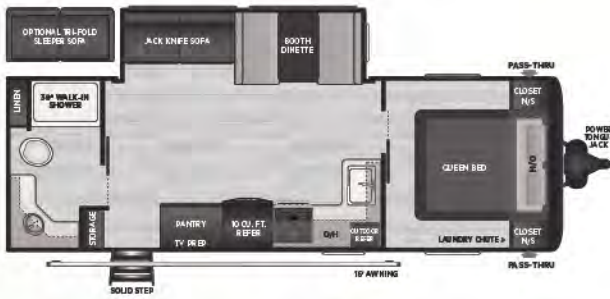

**NEW!** 24RBS | WEIGHT TBD | LENGTH TBD

• SUPER SLIDE, REAR BATH, OUTDOOR KITCHEN

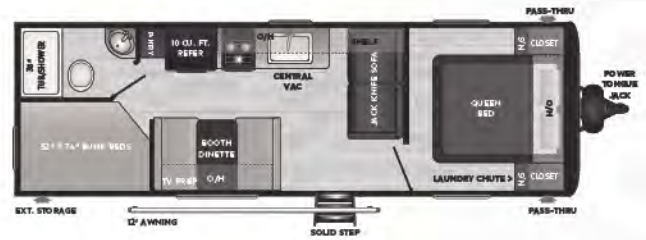

**NEW!** 25BHN | WEIGHT TBD | LENGTH 29' 3"

• NON-SLIDE, DOUBLE BUNKS, PRIVATE BEDROOM

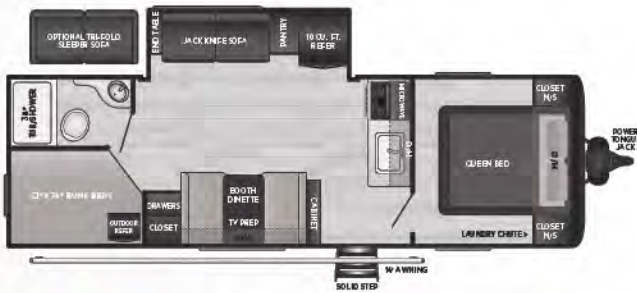

**NEW!** 25BHS | WEIGHT TBD | LENGTH TBD

• COMBO SLIDE, DOUBLE BUNKS, OUTDOOR KITCHEN

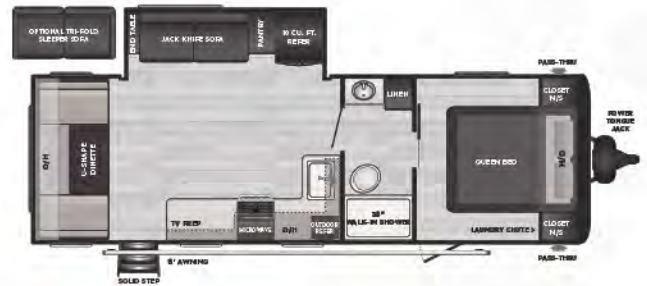

**NEW!** 25RDS | WEIGHT 6195 | LENGTH 29' 7"

• COMBO SLIDE, REAR DINETTE, OUTDOOR KITCHEN

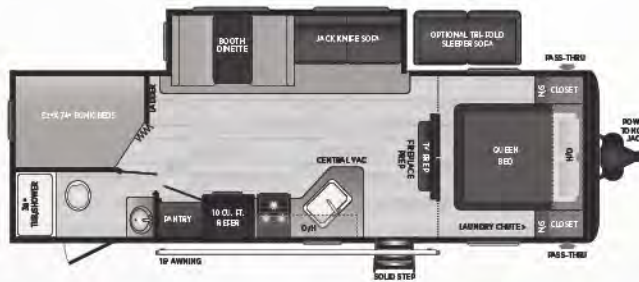

**26BHS** | WEIGHT TBD | LENGTH 30' 8"

• SUPER SLIDE, DOUBLE BUNKS, DOUBLE ENTRY

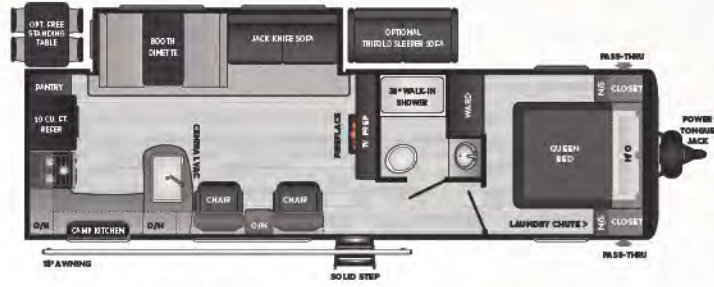

**28RKS** | WEIGHT 7012 | LENGTH 32' 11"

- SUPER SLIDE, REAR KITCHEN, OUTSIDE KITCHEN

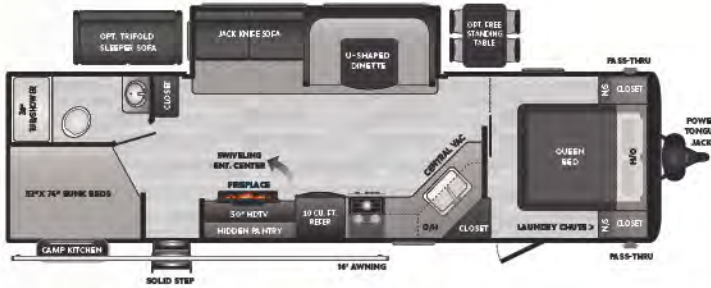

**29DFS** | WEIGHT 7126 | LENGTH 33' 11"

- SUPER SLIDE, DOUBLE BUNKS, HIDDEN PANTRY

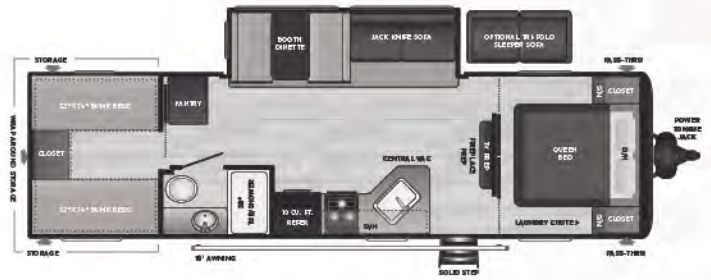

**29QBS** | WEIGHT TBD | LENGTH 33' 3"

- SUPER SLIDE, FOUR SINGLE BUNKS, LARGE WRAP AROUND EXTERIOR STORAGE

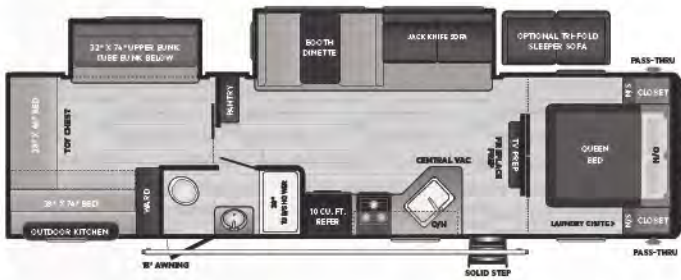

**31BRD** | WEIGHT TBD | LENGTH 35' 11"

- DOUBLE SLIDE, BUNKROOM W/ SLIDE, LARGE OUTSIDE KITCHEN

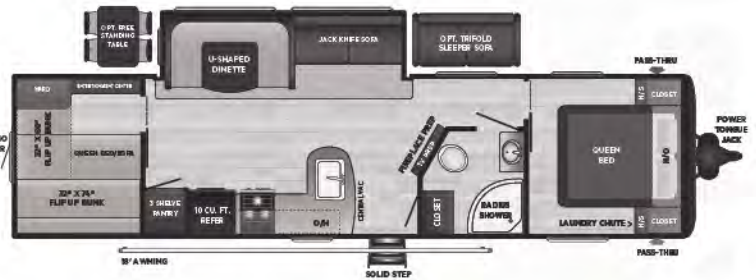

**32LBH** | WEIGHT 7516 | LENGTH 36' 6"

- SUPER SLIDE, BUNKROOM, BIKE DOOR

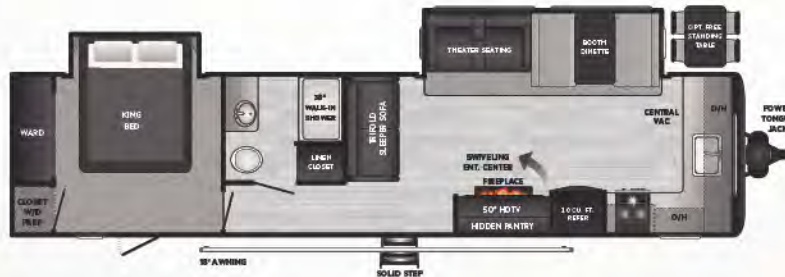

**34FKDS** | WEIGHT 8394 | LENGTH 38' 11"

- DOUBLE SLIDE, KING BED SLIDE, WASHER/DRYER PREP



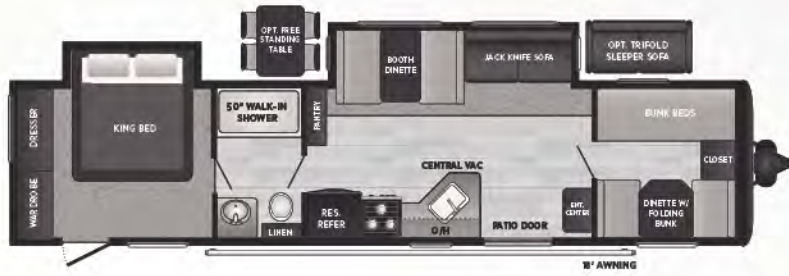

**38HDS** | WEIGHT 8306 | LENGTH 39' 11"  
 • DOUBLE SLIDE, KING BED SLIDE, FRONT BUNKROOM

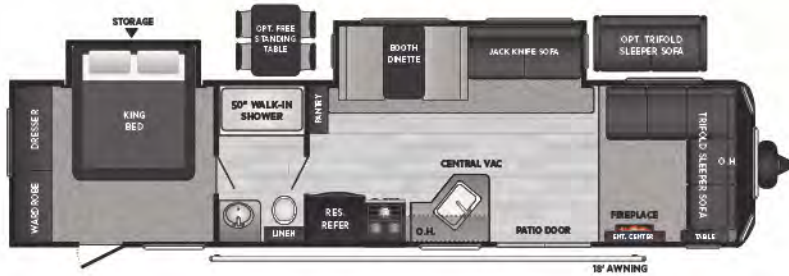

**38FDDS** | WEIGHT 8519 | LENGTH 39' 11"  
 • DOUBLE SLIDE, KING BED SLIDE, FRONT SECTIONAL

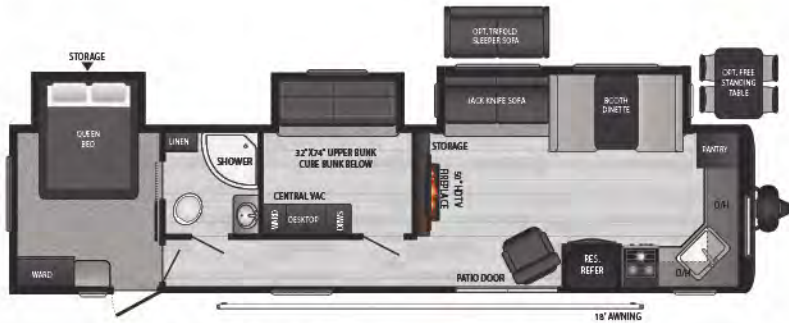

**38FKTS** | WEIGHT 9286 | LENGTH 39' 11"  
 • TRIPLE SLIDE, QUEEN BED SLIDE, MID-BUNKROOM W/ SLIDE

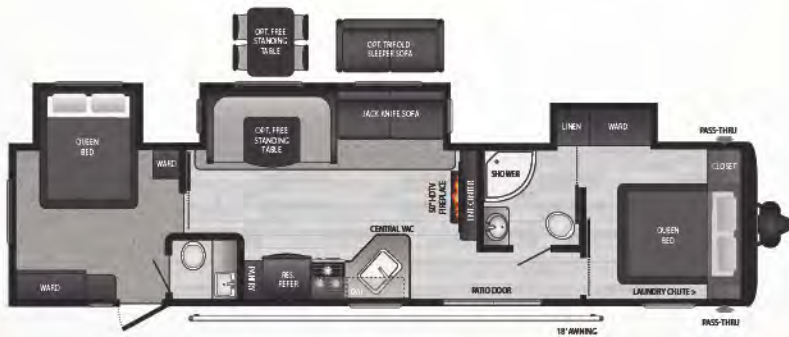

**38FQTS** | WEIGHT 9350 | LENGTH 39' 11"  
 • TRIPLE SLIDE, QUEEN BED SLIDE, FRONT QUEEN W/ WARDROBE SLIDE





# TAKE CHARGE OF HOW YOU CAMP

EXCEPTIONAL QUALITY, IMPOSSIBLY VERSATILE, SolarFlex™ IS SHATTERING CUSTOMER'S EXPECTATIONS OF FACTORY-INSTALLED SOLAR POWER. EXCLUSIVELY AVAILABLE ON ALL KEYSTONE RV MODELS.



Relieve battery anxiety with legendary Lithium-ion deep cycle batteries – the ultimate replacement for lead acid. Lightweight, reliable, and longer-lasting, Dragonfly Energy batteries are made in the USA and available exclusively from Keystone RV and authorized dealers.

## MY KEYSTONE OWNER'S APP

THE ONLY APP YOU'LL NEED...

» MANUALS & QUICK START GUIDES

» HOW-TO VIDEOS



» FIRST-TIME CAMPER'S ADVICE

» ACCESS TO YOUR RV'S MOBILE APPS

Available for iOS and Android devices.



FOLLOW US FOR THE LATEST!



DISCLAIMER: Product information is as accurate as possible as of the date of publication of this brochure. All features, floor plans, and specifications in this brochure are subject to change without notice. Please also consult Keystone's web site at [www.keystonerv.com](http://www.keystonerv.com) for more current product information and specifications. Tow Vehicle Disclaimer. CAUTION: Owners of Keystone recreational vehicles are solely responsible for the selection and proper use of tow vehicles. All customers should consult with a motor vehicle manufacturer or their dealer concerning the purchase and use of suitable tow vehicles for Keystone products. Keystone disclaims any liability or damages suffered as a result of the selection, operation, use or misuse of a tow vehicle. KEYSTONE'S LIMITED WARRANTY DOES NOT COVER DAMAGE TO THE RECREATIONAL VEHICLE OR THE TOW VEHICLE AS A RESULT OF THE SELECTION, OPERATION, USE OR MISUSE OF THE TOW VEHICLE. \*Length is defined as the distance from the centerline of hitch pin/coupler to rear bumper of trailer. \*\* Fresh water capacity includes water heater. Please review owner's manual prior to purchase for more information on service warranties, extended use, towing and maintenance. Owner's manuals can be found at [keystonerv.com](http://keystonerv.com).

PRINT 09.2022

WESTERN EDITION

# HIDEOUT

TRAVEL TRAILERS · SPORT TRAVEL TRAILERS



KEYSTONE  
RV COMPANY

CAMP BETTER





## 2023 HIDEOUT | EXCEPTIONAL FEATURES

- SOLARFLEX™ 200 SOLAR POWER SYSTEM W/OPTIONAL DRAGONFLY ENERGY LITHIUM-ION BATTERY
- **NEW** GIRARD TANKLESS WATER HEATER
- CENTRAL VACUUM (N/A ON SPORT)
- BLADE™ HIGH-PERFORMANCE AIR FLOW SYSTEM (N/A ON SPORT)
- TINTED WINDOWS (N/A ON SPORT)
- PORCELAIN TOILET (N/A ON SPORT)
- **NEW** MEDICINE CABINET ABOVE BATHROOM SINK
- **NEW** RESILIENT VINYL FLOORING IN SLIDE ROOMS (N/A ON SPORT)
- SEAMLESS KITCHEN COUNTERTOPS
- **NEW**.040" SMOOTH METAL FRONT (N/A ON SPORT)
- SOLIDSTEP® AT MAIN ENTRY DOOR (N/A 38s)
- EXTRA-LARGE GRAB HANDLE
- WINEGARD™ AIR 360+ OMNIDIRECTIONAL ANTENNA WITH WI-FI/4G LTE
- POWER STABILIZER JACKS (N/A ON SPORTS & 38s)
- POWER TONGUE JACK (N/A ON SPORT & 38s)

| MODEL            | WEIGHT | CARRYING CAPACITY | HITCH WEIGHT | FRESH WATER** | WASTE WATER | GRAY WATER | LPG | LENGTH* | WIDTH | HEIGHT  | AWNING |
|------------------|--------|-------------------|--------------|---------------|-------------|------------|-----|---------|-------|---------|--------|
| 174RK            | 4085   | 1115              | 525          | 21            | 30          | 30         | 20  | 21' 5"  | 8'    | 10' 2"  | 10'    |
| 175BH            | 3428   | 972               | 485          | 21            | 30          | 30         | 20  | 21' 5"  | 8'    | 10' 2"  | 10'    |
| 176BH            | 3810   | 690               | 520          | 21            | 30          | 30         | 20  | 21' 5"  | 8'    | 10' 2"  | 10'    |
| 177RD            | 3397   | 1003              | 540          | 21            | 30          | 30         | 20  | 21' 5"  | 8'    | 10' 2"  | 10'    |
| 179RB            | 3753   | 727               | 480          | 21            | 32          | 30         | 20  | 21' 5"  | 8'    | 10' 2"  | 10'    |
| 181BH            | TBD    | TBD               | TBD          | 21            | 30          | 60         | 20  | 22' 9"  | 8'    | 10' 4"  | 15'    |
| 186SS            | 4291   | 709               | 610          | 21            | 30          | 30         | 20  | 22' 10" | 8'    | 10' 4"  | 14'    |
| 201BH            | TBD    | TBD               | TBD          | 21            | TBD         | TBD        | TBD | TBD     | 8'    | TBD     | TBD    |
| 20RDNWE (20RDWE) | TBD    | TBD               | TBD          | 54            | TBD         | TBD        | TBD | TBD     | 8'    | TBD     | TBD    |
| 21BHNWE (21BHWE) | TBD    | TBD               | TBD          | 54            | TBD         | TBD        | TBD | TBD     | 8'    | TBD     | TBD    |
| 22MLSWE          | TBD    | TBD               | TBD          | 54            | TBD         | TBD        | TBD | TBD     | 8'    | TBD     | TBD    |
| 24RBSWE          | TBD    | TBD               | TBD          | 54            | TBD         | TBD        | TBD | TBD     | 8'    | TBD     | TBD    |
| 25BHNWE          | TBD    | TBD               | TBD          | 54            | TBD         | TBD        | TBD | TBD     | 8'    | TBD     | TBD    |
| 25BHSWE (25BHWE) | TBD    | TBD               | TBD          | 54            | TBD         | TBD        | TBD | TBD     | 8'    | TBD     | TBD    |
| 25RDSWE          | TBD    | TBD               | TBD          | 54            | TBD         | TBD        | TBD | TBD     | 8'    | TBD     | TBD    |
| 26BHSWE (26BHWE) | TBD    | TBD               | TBD          | 54            | TBD         | TBD        | TBD | TBD     | 8'    | TBD     | TBD    |
| 28BHSWE          | 6731   | 2889              | 820          | 54            | 38          | 78         | 60  | 32' 9"  | 8'    | 11' 1"  | 16'    |
| 28RKSWE          | 6895   | 2645              | 740          | 54            | 38          | 76         | 60  | 32' 11" | 8'    | 11' 1"  | 16'    |
| 29DFSWE          | 7036   | 2544              | 780          | 54            | 38          | 76         | 60  | 33' 11" | 8'    | 11' 1"  | 16'    |
| 29QBSWE (29BQWE) | TBD    | TBD               | TBD          | 54            | TBD         | TBD        | TBD | TBD     | 8'    | TBD     | TBD    |
| 30BHKSWE         | 7468   | 2280              | 948          | 54            | 38          | 38         | 60  | 34' 10" | 8'    | 10' 10" | 16'    |
| 31BRD (31BR)     | TBD    | TBD               | TBD          | 37            | 39          | 69         | 40  | 35' 11" | 8'    | 11' 2"  | 18'    |
| 32LBH            | 7516   | 2284              | 1045         | 37            | 30          | 69         | 40  | 36' 6"  | 8'    | 11' 0"  | 18'    |
| 34FKDS           | 8394   | 1506              | 1100         | 37            | 39          | 78         | 40  | 38' 11" | 8'    | 11' 2"  | 18'    |
| 38BHDS           | 8306   | 1664              | 1170         | 37            | 39          | 39         | 60  | 39' 11" | 8'    | 11' 2"  | 18'    |
| 38FDDS           | 8519   | 1481              | 1205         | 37            | 39          | 39         | 60  | 39' 11" | 8'    | 11' 2"  | 18'    |
| 38FKTS           | 9286   | 1714              | 1200         | 37            | 39          | 78         | 60  | 39' 11" | 8'    | 11' 4"  | 18'    |
| 38FQTS           | 9350   | 2010              | 1200         | 37            | 78          | 78         | 60  | 39' 11" | 8'    | 11' 4"  | 18'    |



# HIDEOUT

Keystone Hideout RVs make it incredibly easy to become a camper. Choose from a wide selection of floorplans from sport travel trailer models to bunkhouses roomy enough for the entire family (and a few neighbor kids)! You'll fall in love with Hideout's airy interiors and dialed-in features – all at affordable price points.



"The layout of our unit is perfect for us. We are retirees with two small dogs. The dinette slideout gives us and the puppies plenty of floor space. The countertop space is great and gives us room for our small TV and food prep. The Murphy bed with the couch is also a big plus. Pulling this small RV with my half-ton is also easy."

TOBIS — HIDEOUT 174RK OWNER

VISIT OUR WEBSITE FOR PHOTOS,  
360° TOURS, AND FULL PRODUCT DETAILS



**NEW TO CAMPING?** Keystone RV's Matt Ardent & Bart Taylor walk you through everything you need to know from your pre-travel checklist to full campsite set-up. You can find this series on Keystone's YouTube channel or follow this QR code to our website.



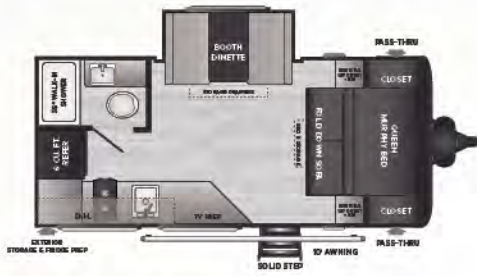

**174RK** | WEIGHT 4085 | LENGTH 21' 5"

**SPORT** • BOOTH DINETTE, REAR KITCHEN SLIDE, MURPHY BED

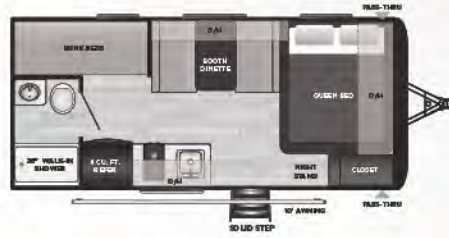

**175BH** | WEIGHT 3428 | LENGTH 21' 5"

**SPORT** • NON-SLIDE, SINGLE BUNKS

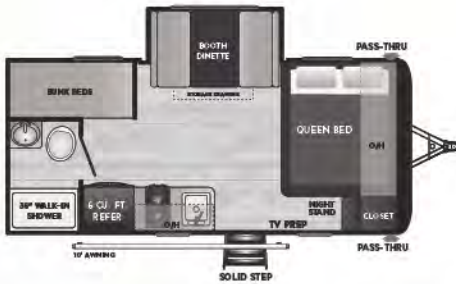

**176BH** | WEIGHT 3810 | LENGTH 21' 5"

**SPORT** • BOOTH DINETTE SLIDE, SINGLE BUNKS

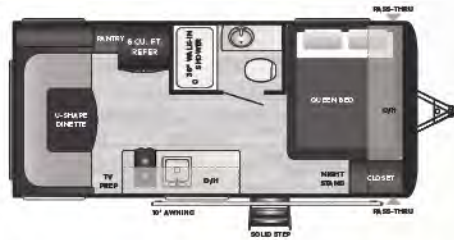

**177RD** | WEIGHT 3397 | LENGTH 21' 5"

**SPORT** • NON-SLIDE, REAR DINETTE

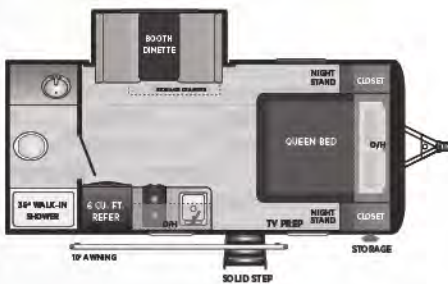

**179RB** | WEIGHT 3753 | LENGTH 21' 5"

**SPORT** • BOOTH DINETTE SLIDE, REAR BATHROOM

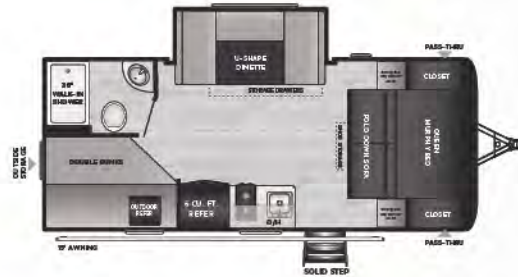

**181BH** | WEIGHT 4580 | LENGTH 22' 9"

**SPORT** • U-SHAPE DINETTE SLIDE, DOUBLE BUNKS, MURPHY BED

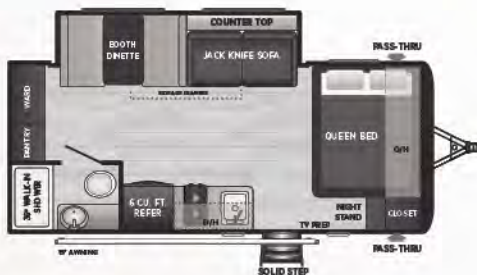

**186SS** | WEIGHT 4291 | LENGTH 22' 10"

**SPORT** • SUPER SLIDE, REAR PANTRY/WARDROBE

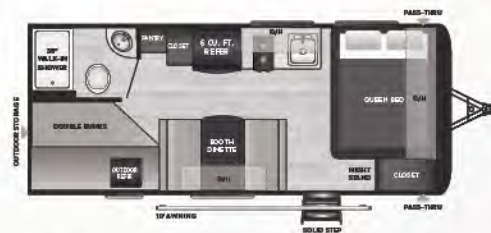

**201BH** | WEIGHT TBD | LENGTH TBD

**SPORT** • NON-SLIDE, DOUBLE BUNKS

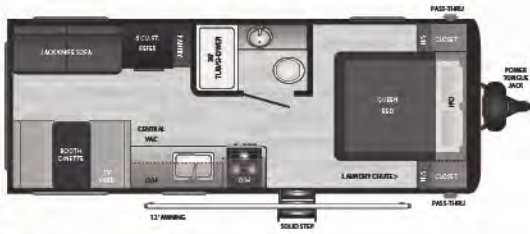

**20RDNWE** | WEIGHT TBD | LENGTH TBD

• NON-SLIDE, REAR DINETTE, LARGE REAR WINDOWS

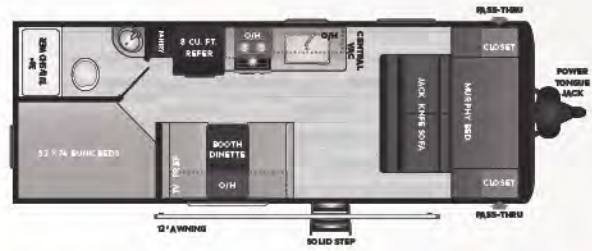

**21BHNWE** | WEIGHT TBD | LENGTH TBD

• NON-SLIDE, DOUBLE BUNKS, MURPHY BED

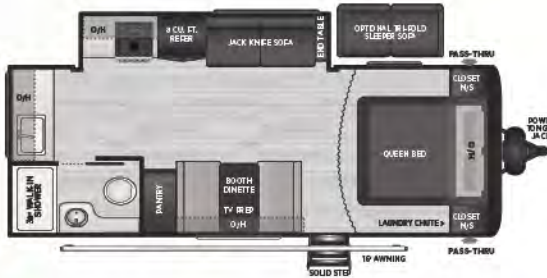

**NEW!** **22MLSWE** | WEIGHT TBD | LENGTH TBD

• COMBO SLIDE, MIDDLE LIVING, OPEN CONCEPT

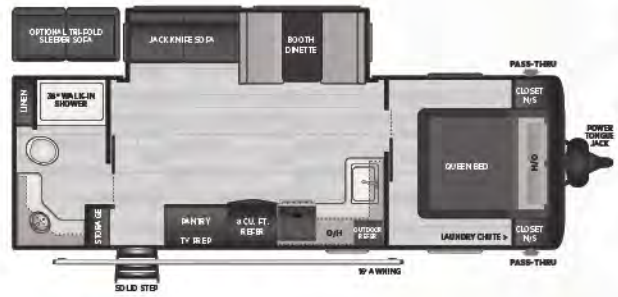

**NEW!** **24RBSWE** | WEIGHT TBD | LENGTH TBD

• SUPER SLIDE, REAR BATH, OUTDOOR KITCHEN

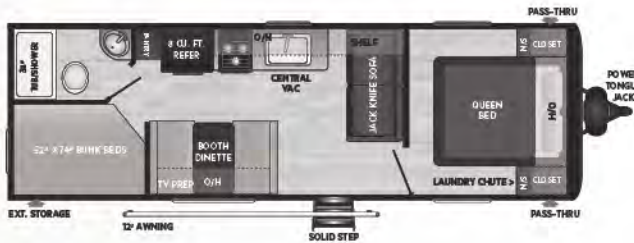

**25BHNWE** | WEIGHT TBD | LENGTH TBD

• NON-SLIDE, DOUBLE BUNKS, PRIVATE BEDROOM

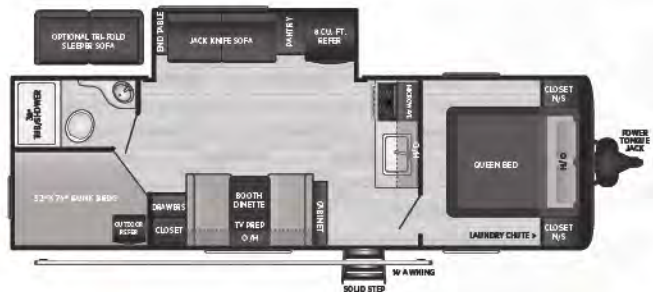

**NEW!** **25BHSWE** | WEIGHT TBD | LENGTH TBD

• COMBO SLIDE, DOUBLE BUNKS, OUTDOOR KITCHEN

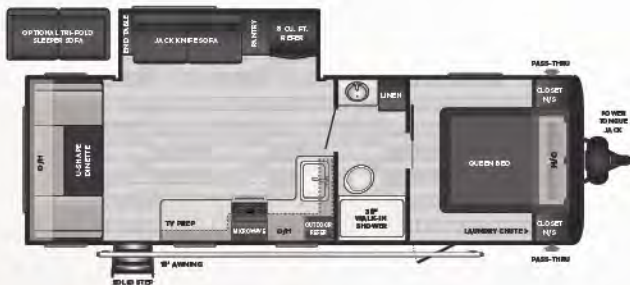

**NEW!** **25RDSWE** | WEIGHT TBD | LENGTH TBD

• COMBO SLIDE, REAR DINETTE, OUTDOOR KITCHEN

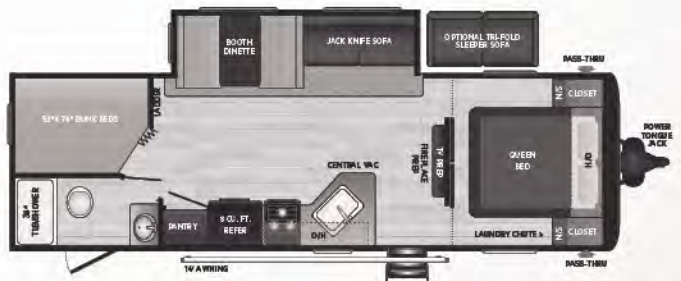

**26BHSWE** | WEIGHT TBD | LENGTH TBD

• SUPER SLIDE, DOUBLE BUNKS, DOUBLE ENTRY



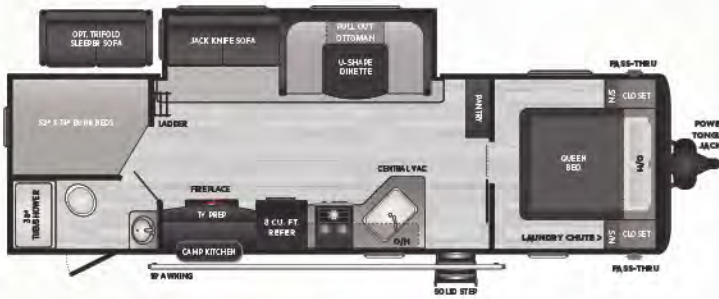

**28BHSWE** WEIGHT 6731 LENGTH 32' 9"

• SUPER SLIDE, DOUBLE BUNKS, OUTSIDE KITCHEN



**28RKSWE** WEIGHT 6895 LENGTH 32' 11"

• SUPER SLIDE, REAR KITCHEN, OUTSIDE KITCHEN

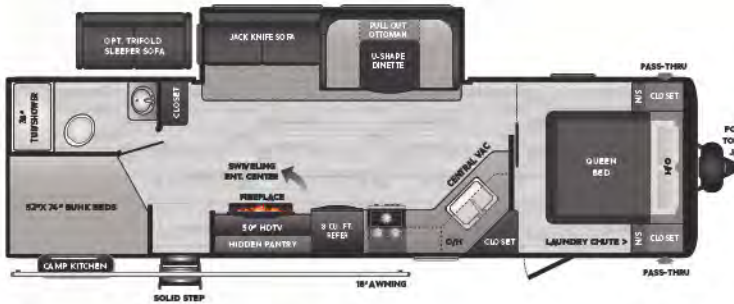

**29DFSWE** WEIGHT 7036 LENGTH 32' 11"

• SUPER SLIDE, DOUBLE BUNKS, HIDDEN PANTRY

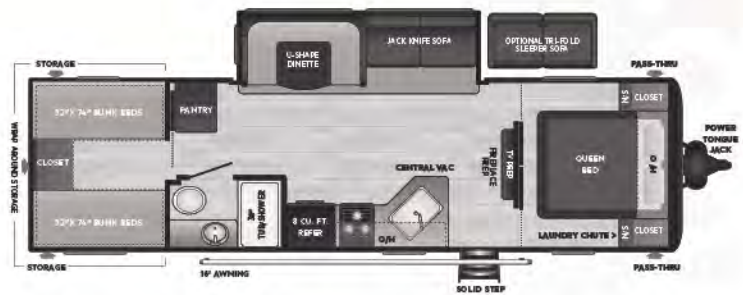

**29QBSWE** WEIGHT TBD LENGTH TBD

• SUPER SLIDE, FOUR SINGLE BUNKS, LARGE WRAP AROUND EXTERIOR STORAGE

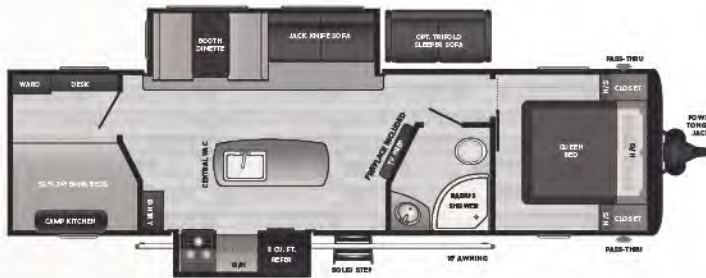

**30BHKSWE** WEIGHT 7468 LENGTH 34' 10"

• DOUBLE SLIDES, BUNKROOM, ISLAND KITCHEN

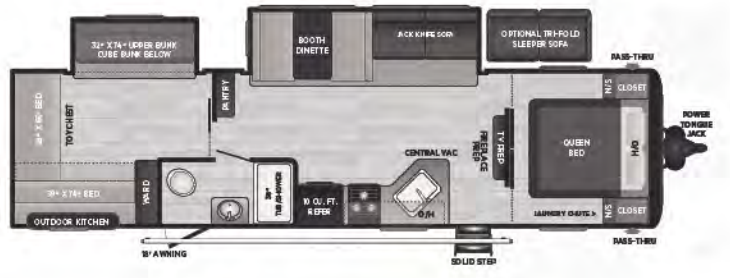

**31BRD** WEIGHT TBD LENGTH 35' 11"  
EASTERN • DOUBLE SLIDE, BUNKROOM W/ SLIDE, LARGE OUTSIDE KITCHEN

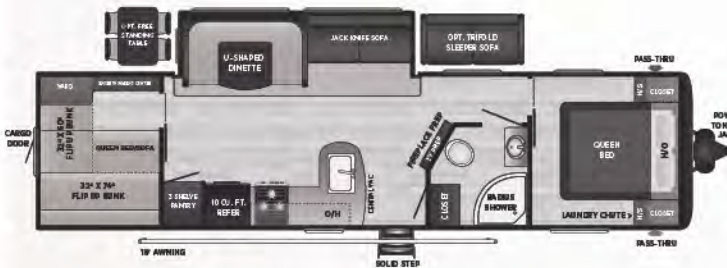

**32LBH** WEIGHT 7516 LENGTH 36' 6"

EASTERN • SUPER SLIDE, BUNKROOM, BIKE DOOR

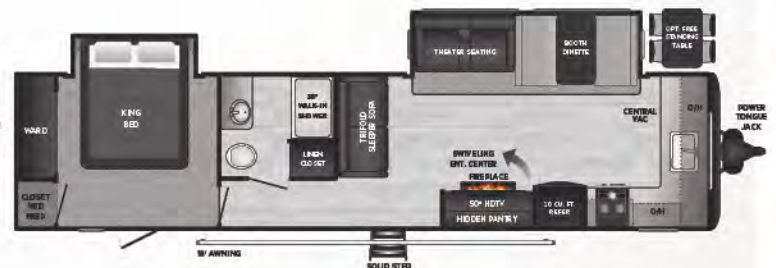

**34FKDS** WEIGHT 8394 LENGTH 38' 11"

EASTERN • DOUBLE SLIDE, KING BED SLIDE, WASHER/DRYER PREP

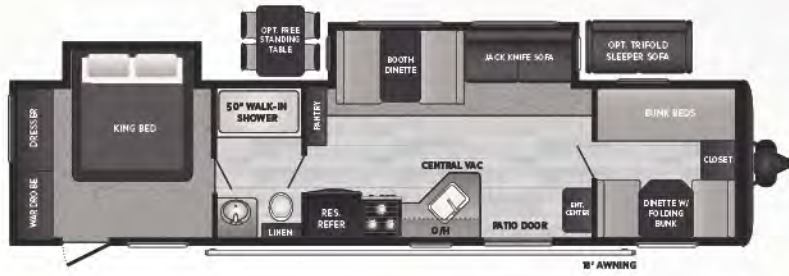

**38HDS** | WEIGHT 8306 | LENGTH 39' 11"

**EASTERN** • DOUBLE SLIDE, KING BED SLIDE, FRONT BUNKROOM

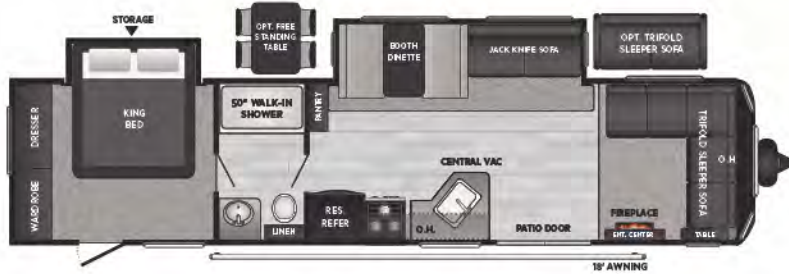

**38FDDS** | WEIGHT 8519 | LENGTH 39' 11"

**EASTERN** • DOUBLE SLIDE, KING BED SLIDE, FRONT SECTIONAL

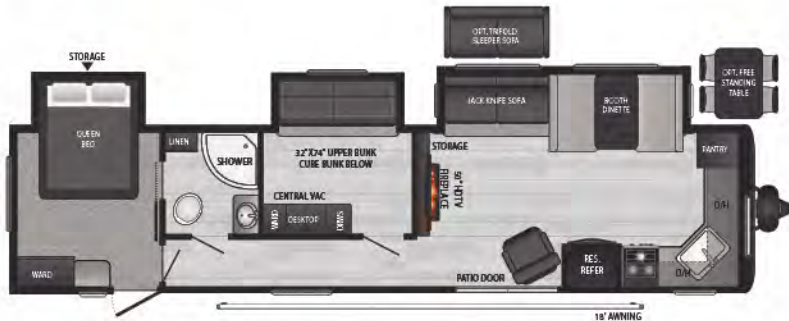

**38FKTS** | WEIGHT 9286 | LENGTH 39' 11"

**EASTERN** • TRIPLE SLIDE, QUEEN BED SLIDE, MID-BUNKROOM W/ SLIDE

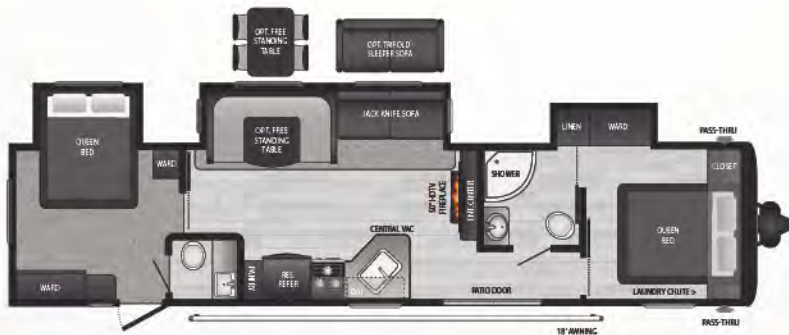

**38FQTS** | WEIGHT 9350 | LENGTH 39' 11"

**EASTERN** • TRIPLE SLIDE, QUEEN BED SLIDE, FRONT QUEEN W/ WARDROBE SLIDE





# TAKE CHARGE OF HOW YOU CAMP

EXCEPTIONAL QUALITY, IMPOSSIBLY VERSATILE, SolarFlex™ IS SHATTERING CUSTOMER'S EXPECTATIONS OF FACTORY-INSTALLED SOLAR POWER. EXCLUSIVELY AVAILABLE ON ALL KEYSTONE RV MODELS.



Relieve battery anxiety with legendary Lithium-ion deep cycle batteries – the ultimate replacement for lead acid. Lightweight, reliable, and longer-lasting, Dragonfly Energy batteries are made in the USA and available exclusively from Keystone RV and authorized dealers.

## MY KEYSTONE OWNER'S APP

THE ONLY APP YOU'LL NEED...

» MANUALS & QUICK START GUIDES

» HOW-TO VIDEOS



» FIRST-TIME CAMPER'S ADVICE

» ACCESS TO YOUR RV'S MOBILE APPS

Available for iOS and Android devices.



FOLLOW US FOR THE LATEST!



DISCLAIMER: Product information is as accurate as possible as of the date of publication of this brochure. All features, floor plans, and specifications in this brochure are subject to change without notice. Please also consult Keystone's web site at [www.keystonerv.com](http://www.keystonerv.com) for more current product information and specifications. Tow Vehicle Disclaimer. CAUTION: Owners of Keystone recreational vehicles are solely responsible for the selection and proper use of tow vehicles. All customers should consult with a motor vehicle manufacturer or their dealer concerning the purchase and use of suitable tow vehicles for Keystone products. Keystone disclaims any liability or damages suffered as a result of the selection, operation, use or misuse of a tow vehicle. KEYSTONE'S LIMITED WARRANTY DOES NOT COVER DAMAGE TO THE RECREATIONAL VEHICLE OR THE TOW VEHICLE AS A RESULT OF THE SELECTION, OPERATION, USE OR MISUSE OF THE TOW VEHICLE. \*Length is defined as the distance from the centerline of hitch pin/coupler to rear bumper of trailer. \*\* Fresh water capacity includes water heater. Please review owner's manual prior to purchase for more information on service warranties, extended use, towing and maintenance. Owner's manuals can be found at [keystonerv.com](http://keystonerv.com).

PRINT 09.2022